

GENERAL NOTES

1. **Do not scale drawings.** Written dimensions shall have precedence over scaled dimensions.
2. All work shall comply with the 2012 Ontario Building Code and amendments.
3. Contractors must check and verify all dimensions and specifications and report any discrepancies to the architect before proceeding with the work.
4. All contractors and sub-contractors shall have a set of approved construction documents on site at all times.
5. All documents remain the property of the architect.
Unauthorized use, modification, and/or reproduction of these documents is prohibited without written permission. The contract documents were prepared by the consultant for the account of the owner.
6. The material contained herein reflects the consultants best judgment in light of the information available to him at the time of preparation. Any use which a third party makes of the contract documents, or any reliance on/or decisions to be made based on them are the responsibility of such third parties.
7. The consultant accepts no responsibility for damages, if any, suffered by any third party as a result of decisions made or actions taken on the basis of the information contained herein.

2	2025-03-28	ISSUED FOR SPA
1	2025-03-19	ISSUED FOR DISCUSSION
No.	Date	Revision

Client



Project Name / Address

**BWDSB
HIGHPOINT COMMUNITY
SCHOOL**

The image shows the logo for SRM architects+urban*designers, which consists of the letters 'SRM' in a large, bold, sans-serif font, followed by an upward-pointing arrow. Below this, the words 'architects+' and 'urban*designers' are stacked in a smaller, lowercase sans-serif font. To the right of the logo is a white rectangular box containing project information. The box has a thin black border and is divided into sections by horizontal lines. The top section contains 'Project No:' followed by a large, bold '2501'. The second section contains 'Drawing Date:' followed by '2024-11-01'. The third section contains 'Drawn by:' followed by 'MS' and 'Checked by:' followed by 'JA'. The fourth section contains 'Office Location:' followed by 'KITCHENER'. The bottom section contains 'Plot Date / Time:' followed by '2025-03-28 2:40:09 PM'.

SITE DEMO PLAN



Drawing Scale: _____

Status: ISSUED FOR

Revision No.:

Drawing No.:

A1.0

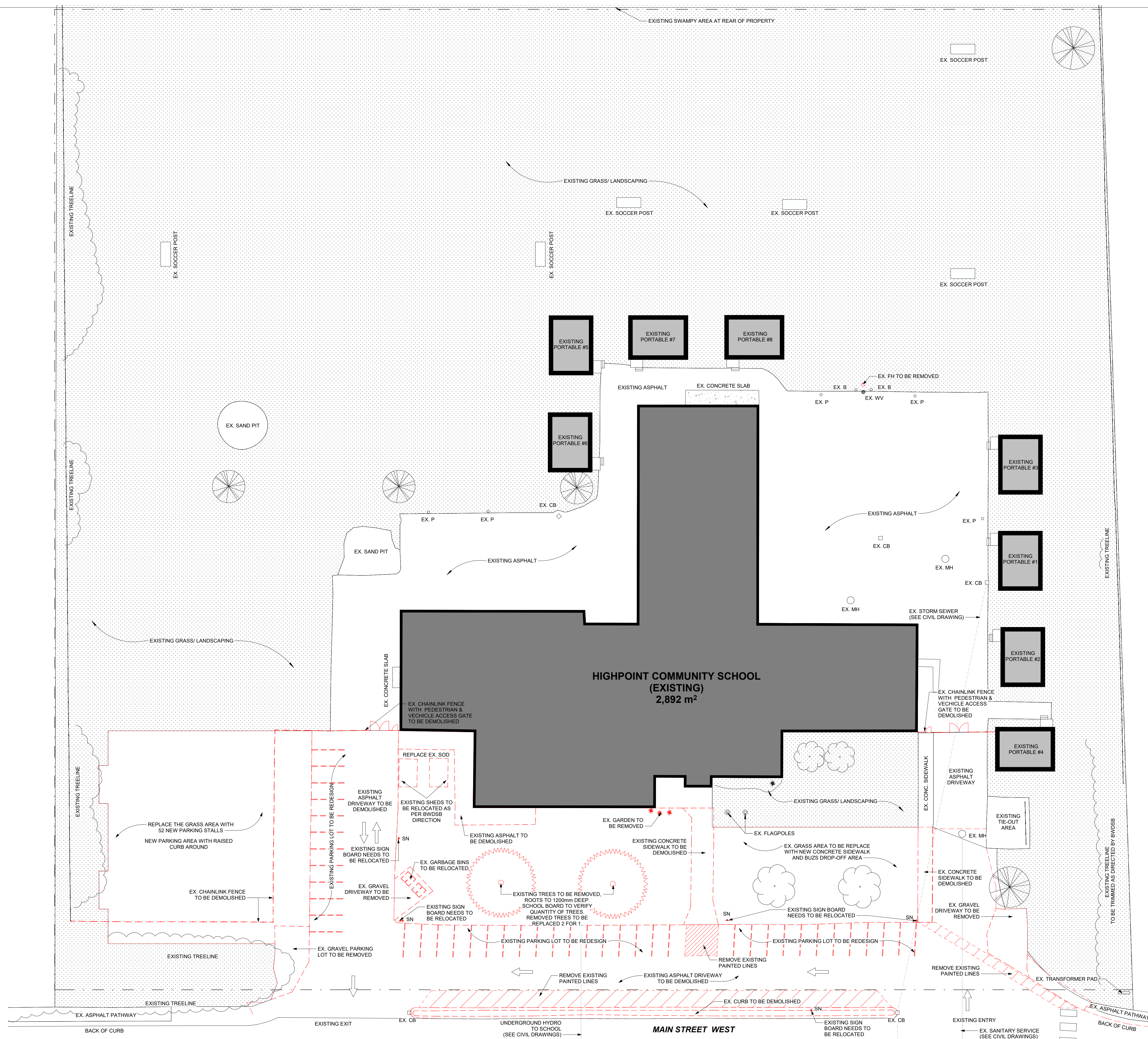

NOTE

1. As per Municipality of Southgate requirement, for each existing trees removed BWDSB will supply & install two new trees. Size, type and placement to be at BWDSB direction.
2. Contractor to review Geotechnical & Chemical analysis reports, as prepared by CMT January 2025, as part of this tender.
3. See Civil drawings for the approximate locations of water, sewer and sanitary details.

1 SITE DEMO PLAN
1 : 300

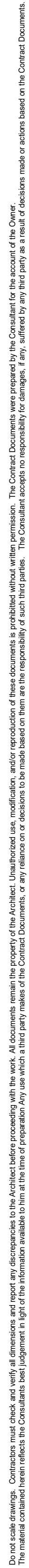

NOTE

1. As per Municipality of Southgate requirement, for each existing trees removed, BWDSB will supply & install two new trees. Size, type and placement to be at BWDSB direction.
2. Contractor to review Geotechnical & Chemical analysis reports, as prepared by CMT January 2025, as part of this tender.
3. See Civil drawings for the approximate locations of water, sewer and sanitary details

GENERAL NOTES

1. **Do not scale drawings.** Written dimensions shall have precedence over scaled dimensions.
2. All work shall comply with the 2012 Ontario Building Code and amendments.
3. Contractors must check and verify all dimensions and specifications and report any discrepancies to the architect before proceeding with the work.
4. All contractors and sub-contractors shall have a set of approved construction documents on site at all times.
5. All documents remain the property of the architect. Unauthorized use, modification, and/or reproduction of these documents is prohibited without written permission. The contract documents were prepared by the consultant for the account of the owner.
6. The material contained herein reflects the consultants best judgement in light of the information available to him at the time of preparation. Any use which a third party makes of the contract documents, or any reliance on/or decisions to be made based on them are the responsibility of such third parties.
7. The consultant accepts no responsibility for damages, if any, suffered by any third party as a result of decisions made or actions based on the contract documents.

LEGEND

- FH - FIRE HYDRANT
B - BOLLARD
P - POST/POLE
FP - NEW FLAGPOLE
SN - SIGNAGE
HP - HYDRO POLE
► - ENTRY DOOR POINT
CB - CATCH BASIN
MB - MAIL BOX
MH - MAINTENANCE HOLE
HH - HAND HOLE
WV - WATER VALVE
ALL DIMENSIONS ARE IN METERS

Client



**BWDSB
HIGHPOINT COMMUNITY
SCHOOL**

SRM ↗
architects+
urban*designers

Drawing Name



Drawing Scale:

Status: ISSUED FOR

Revision No.: 3

Drawing No.:

A1.1