

Prepare structural drawings base on order to comply #20250109074833 (a building permit concrete patio at rear of house.) that already had been installed and completed.

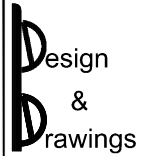

GENERAL NOTES:
1. DRAWINGS ARE TO BE READ NOT SCALED.
2. CONFORM TO THE REQUIREMENTS OF THE ONTARIO BUILDING CODE INCLUDING ALL STANDARDS REFERENCED THEREIN AND ANY APPLICABLE ACTS OF HAVING JURISDICTION (THE LATEST VERSION OF STANDARDS AND CODES SHALL APPLY).
3. CONTRACTOR SHALL CHECK ALL DIMENSIONS ON WORKING DRAWINGS AND REPORT ANY DISCREPANCIES TO THE ENGINEER BEFORE PROCEEDING. ANY CHANGES, ALTERATIONS, OR REVISIONS MUST BE REPORTED TO ENGINEER BEFORE PROCEEDING WITH WORK.
4. THE LATEST DRAWINGS SHOULD BE USED BY CONTRACTOR.

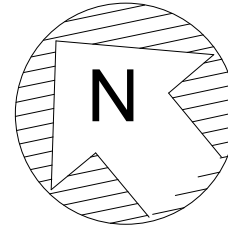

APPROVED BY:

Prepare structural drawings base on order to comply #20250109074833 (a building permit concrete patio at rear of house,) that already had been installed and completed

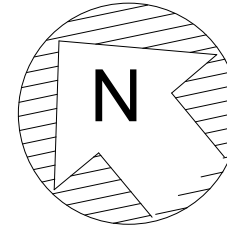

GENERAL NOTES:
1. DRAWINGS ARE TO BE READ NOT SCALED.
2. CONFORM TO THE REQUIREMENTS OF THE ONTARIO BUILDING CODE INCLUDING ALL STANDARDS REFERENCED THEREIN AND ANY APPLICABLE ACTS OF HAVING JURISDICTION (THE LATEST VERSION OF STANDARDS AND CODES SHALL APPLY).
3. CONTRACTOR SHALL CHECK ALL DIMENSIONS ON WORKING DRAWINGS AND REPORT ANY DISCREPANCIES TO THE ENGINEER BEFORE PROCEEDING. ANY CHANGES, ALTERATIONS, OR REVISIONS MUST BE REPORTED TO ENGINEER BEFORE PROCEEDING WITH WORK.
4. THE LATEST DRAWINGS SHOULD BE USED BY CONTRACTOR.



DESIGN PROFESSIONAL
ENGINEERING INC.

PROJECT:

196 Werry Ave,
Southgate

DRAWING TITLE:

Proposed Site Plan

DATE:

SCALE:
3/16": 1'-0"

PROJECT NO:

11-01

DRAWING NO:

CHECKED BY:

A-2

APPROVED BY:

Apply permit base on order to comply
#20250109074833 (a building permit
concrete patio at rear of house.)
that already had been installed & completed.

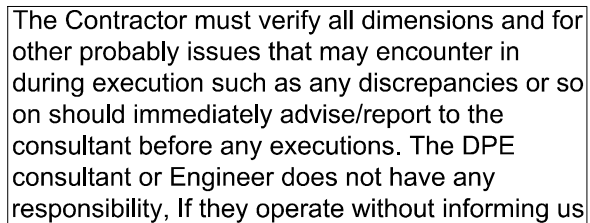

Portion of house with Ex. Concrete Deck at rear

CHECKED BY:	A-3
APPROVED BY:	

Scope of work
Apply permit base on order to comply
#20250109074833 (a building permit
concrete patio at rear of house.)
that already had been installed & completed.

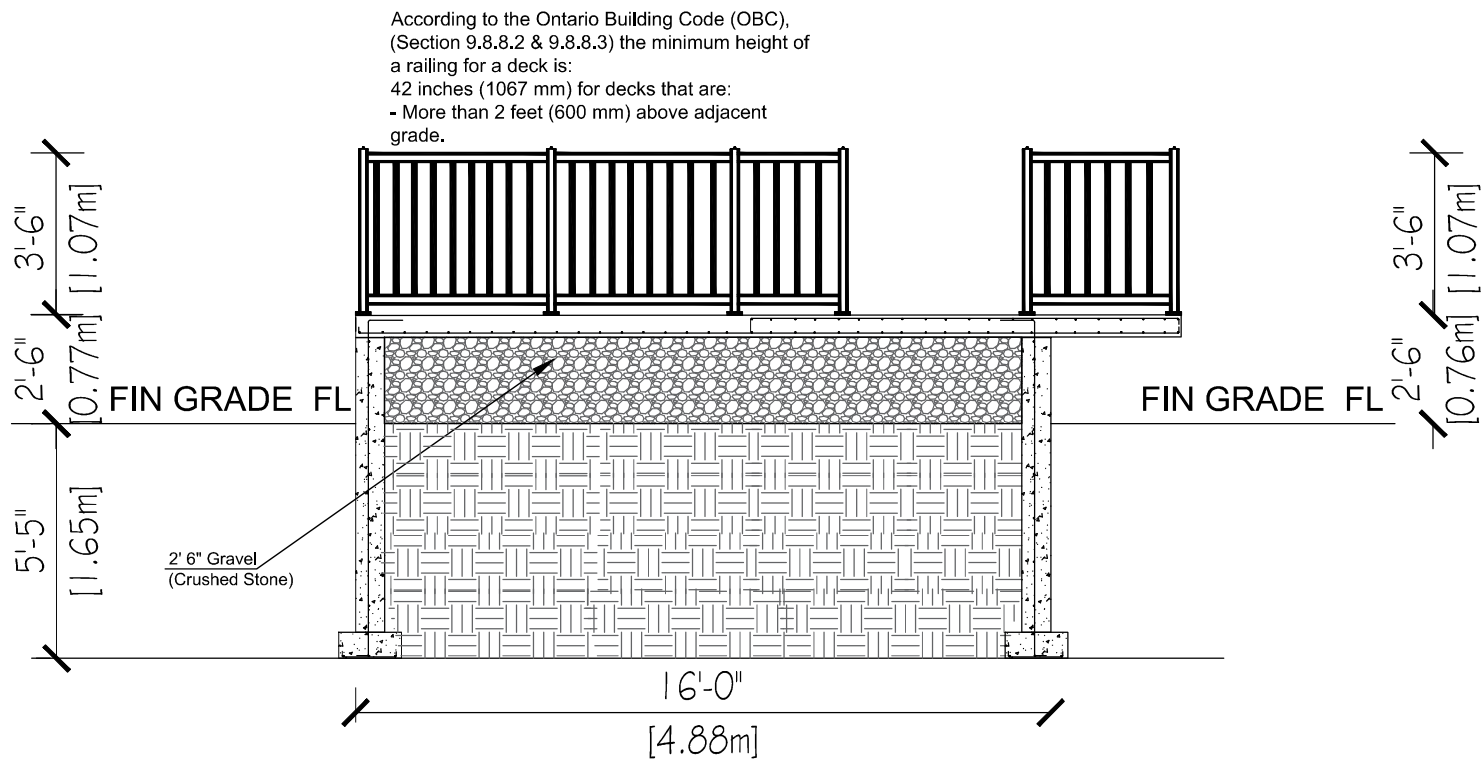

The Contractor must verify all dimensions and for other probably issues that may encounter in during execution such as any discrepancies or so on should immediately advise/report to the consultant before any executions. The DPE consultant or Engineer does not have any responsibility, If they operate without informing us

Section A-A Railing

Design & Drawings
Design Professional Engineering Inc.
23 LORRAINE DR, NORTH YORK
Call (647) 388-8653 permitcity@yahoo.ca

GENERAL NOTES:
1. DRAWINGS ARE TO BE READ NOT SCALED.
2. CONFORM TO THE REQUIREMENTS OF THE ONTARIO BUILDING CODE INCLUDING ALL STANDARDS REFERENCED THEREIN AND ANY APPLICABLE ACTS OF HAVING JURISDICTION (THE LATEST VERSION OF STANDARDS AND CODES SHALL APPLY).
3. CONTRACTOR SHALL CHECK ALL DIMENSIONS ON WORKING DRAWINGS AND REPORT ANY DISCREPANCIES TO THE ENGINEER BEFORE PROCEEDING ANY CHANGES, ALTERATIONS, OR REVISIONS MUST BE REPORTED TO ENGINEER BEFORE PROCEEDING WITH WORK.
4. THE LATEST DRAWINGS SHOULD BE USED BY CONTRACTOR.



PROJECT:
196 Werry Ave,
Southgate

DRAWING TITLE:
Section A-A
Railing

DATE:	PROJECT NO:
SCALE: 3/16" = 1'-0"	11-01
CHECKED BY:	DRAWING NO:
APPROVED BY:	A-4

Apply permit base on order to comply
#20250109074833 (a building permit
concrete patio at rear of house.)
that already had been installed &
completed .

According to the Ontario Building Code (OBC),
(Section 9.8.8.2 & 9.8.8.3) the minimum height of
a railing for a deck is:
42 inches (1067 mm) for decks that are:
- More than 2 feet (600 mm) above adjacent
grade.

The diagram shows a cross-section of a deck and its foundation. The deck is 20'-0" [6.09m] wide and 5'-5" [1.65m] high from the finish grade. The railing is 3'-6" [1.07m] high. The deck is supported by a 2'-6" [0.76m] layer of gravel (crushed stone) on top of a concrete foundation. The foundation is 2'-6" [0.76m] high and 20'-0" [6.09m] wide. The deck is located on the exterior of the house, adjacent to the main floor and basement floor. The railing is 42 inches (1067 mm) high. The deck is more than 2 feet (600 mm) above adjacent grade.

FIN GRADE

2'-6" [0.76m]

3'-6" [1.07m]

5'-5" [1.65m]

2'-6" Gravel
(Crushed Stone)

20'-0" [6.09m]

Ex. House
Main Floor

Ex. House
Basement Floor

Ex. footing and
foundation wall of
house

Section B-B

Railing

CHECKED BY:	A-5
APPROVED BY:	

Scope of work
Apply permit base on order to comply
#20250109074833 (a building permit
concrete patio at rear of house.)
that already had been installed & completed.

Note 1: The owner claims to have excavated the foundation wall and footing 5'5" below grade, allegedly for forest protection, that exceeds the required depth of 4' down, the city inspector should verify since this job completed before getting permit.

Note 2: The owner claims to have installed footing size 24"x12", which exceeds the required size of 20"x10". the city inspector should verify since this job completed before getting permit

The Contractor must verify all dimensions and for other probably issues that may encounter in during execution such as any discrepancies or so on should immediately advise/report to the consultant before any executions. The DPE consultant or Engineer does not have any responsibility, If they operate without informing us

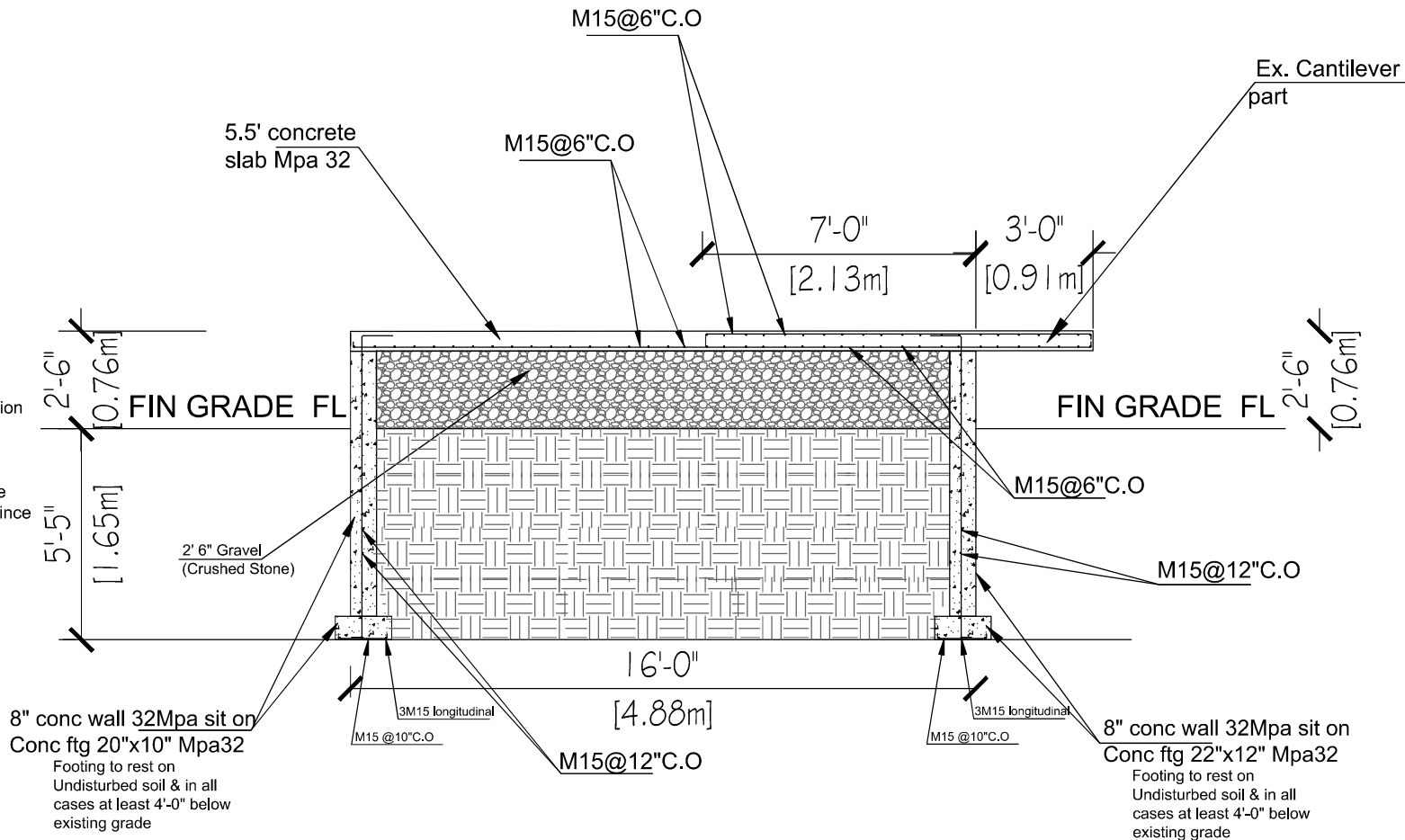

Section A-A Structural Detail

Design
&
Drawings

Design Professional Engineering Inc.
23 LORRAINE DR, NORTH YORK
Call (647) 388-8653 permitcity@yahoo.ca

GENERAL NOTES:
1. DRAWINGS ARE TO BE READ NOT SCALED.
2. CONFORM TO THE REQUIREMENTS OF THE ONTARIO BUILDING CODE INCLUDING ALL STANDARDS REFERENCED THEREIN AND ANY APPLICABLE ACTS OF HAVING JURISDICTION (THE LATEST VERSION OF STANDARDS AND CODES SHALL APPLY).
3. CONTRACTOR SHALL CHECK ALL DIMENSIONS ON WORKING DRAWINGS AND REPORT ANY DISCREPANCIES TO THE ENGINEER BEFORE PROCEEDING. ANY CHANGES, ALTERATIONS, OR REVISIONS MUST BE REPORTED TO ENGINEER BEFORE PROCEEDING WITH WORK.
4. THE LATEST DRAWINGS SHOULD BE USED BY CONTRACTOR.



PROJECT:
196 Werry Ave,
Southgate

DRAWING TITLE:
Section A-A
Structural

DATE:
SCALE: 3/16" = 1'-0"
PROJECT NO: 11-01
DRAWING NO:
CHECKED BY:
APPROVED BY:

A-6

Scope of work
Apply permit base on order to comply
#20250109074833 (a building permit
concrete patio at rear of house.)
that already had been installed & completed.

Note 1: The owner claims to have excavated the foundation wall and footing 5'5" below grade, allegedly for forest protection, that exceeds the required depth of 4' down, the city inspector should verify since this job completed before getting permit.

10" sono tube concrete
Mpa 25, 4' below grade

Note 2: The owner claims to have installed footing size 24"x12", which exceeds the required size of 20"x10". the city inspector should verify since this job completed before getting permit

The Contractor must verify all dimensions and for other probably issues that may encounter in during execution such as any discrepancies or so on should immediately advise/report to the consultant before any executions. The DPE consultant or Engineer does not have any responsibility, If they operate without informing us

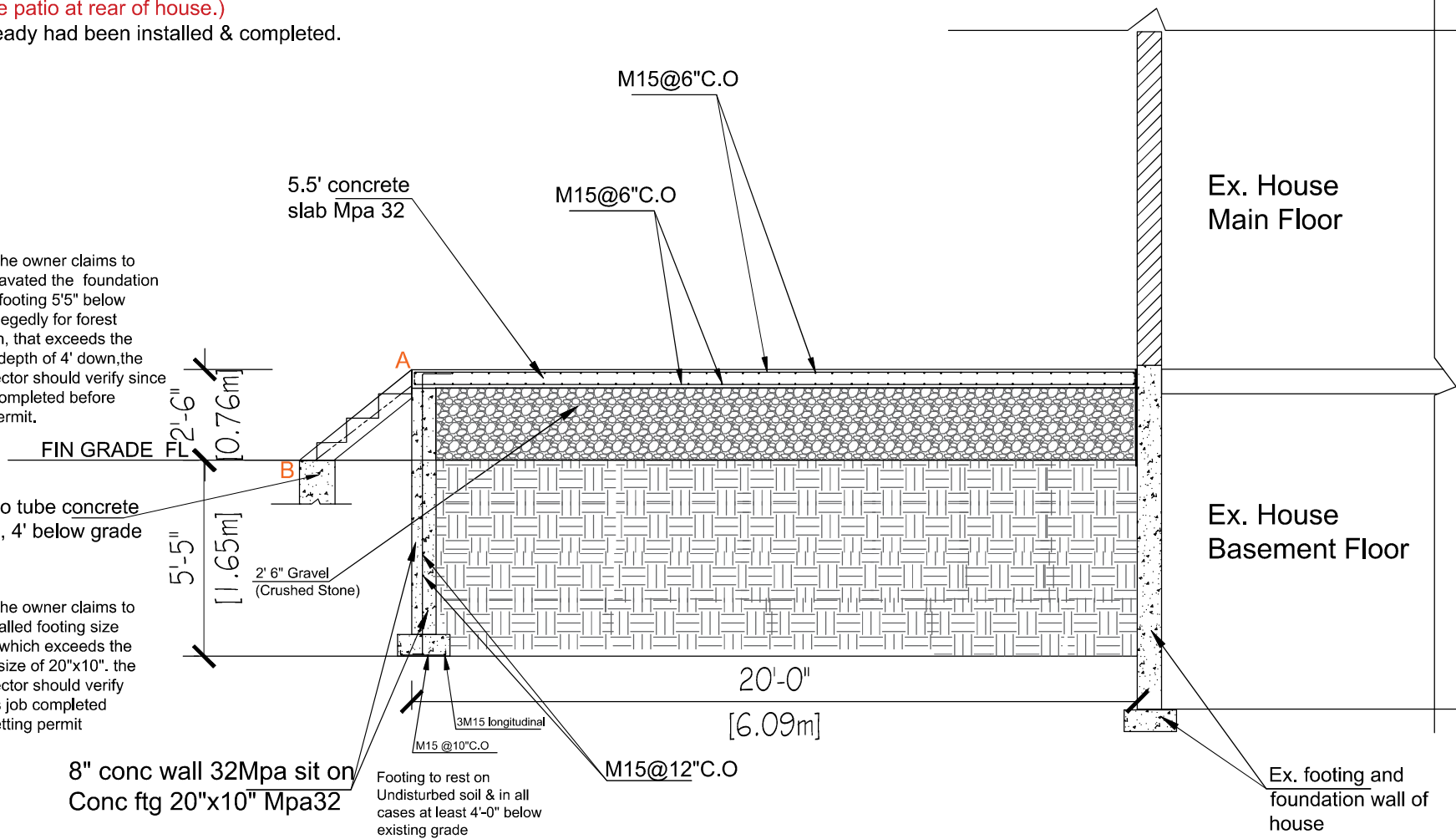

Section B-B Structural Detail

Design & Drawings
Design Professional Engineering Inc.
23 LORRAINE DR, NORTH YORK
Call (647) 338-8633 permitcity@yahoo.ca

GENERAL NOTES:
1. DRAWINGS ARE TO BE READ NOT SCALED.
2. CONFORM TO THE REQUIREMENTS OF THE ONTARIO BUILDING CODE INCLUDING ALL STANDARDS REFERENCED THEREIN AND ANY APPLICABLE ACTS OF HAVING JURISDICTION (THE LATEST VERSION OF STANDARDS AND CODES SHALL APPLY).
3. CONTRACTOR SHALL CHECK ALL DIMENSIONS ON WORKING DRAWINGS AND REPORT ANY DISCREPANCIES TO THE ENGINEER BEFORE PROCEEDING ANY CHANGES, ALTERATIONS, OR REVISIONS MUST BE REPORTED TO ENGINEER BEFORE PROCEEDING WITH WORK.
4. THE LATEST DRAWINGS SHOULD BE USED BY CONTRACTOR.



PROJECT:
196 Werry Ave,
Southgate

DRAWING TITLE:
Section B-B
Structural

DATE:
SCALE: 3/16" = 1'-0"

PROJECT NO:
11-01
DRAWING NO:

CHECKED BY:
APPROVED BY:
A-7

Scope of work
Apply permit base on order to comply
#20250109074833 (a building permit
concrete patio at rear of house.)
that already had been installed & completed.

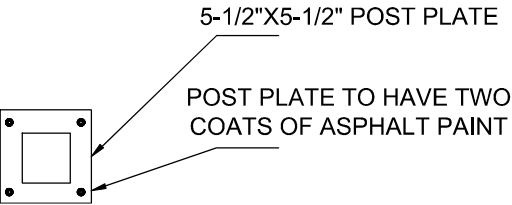

Post plate railing

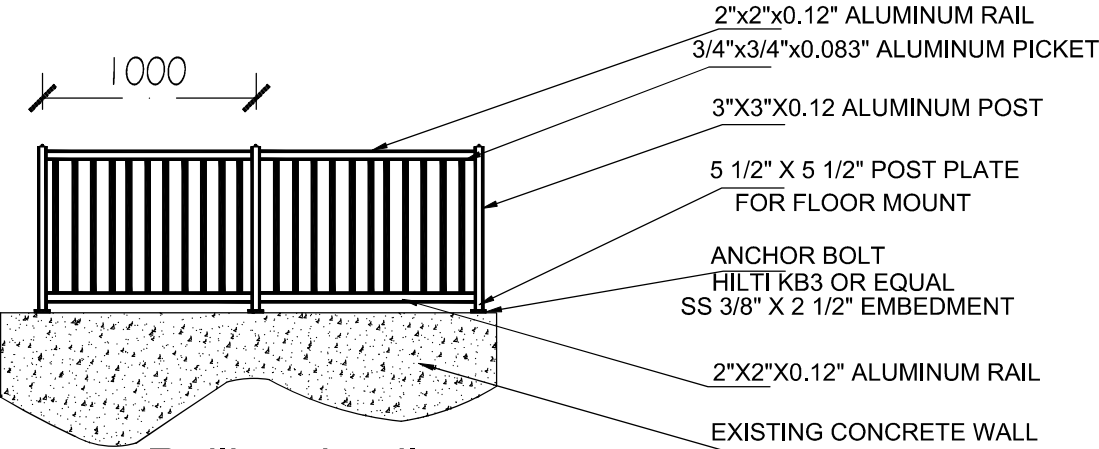

Railing detail

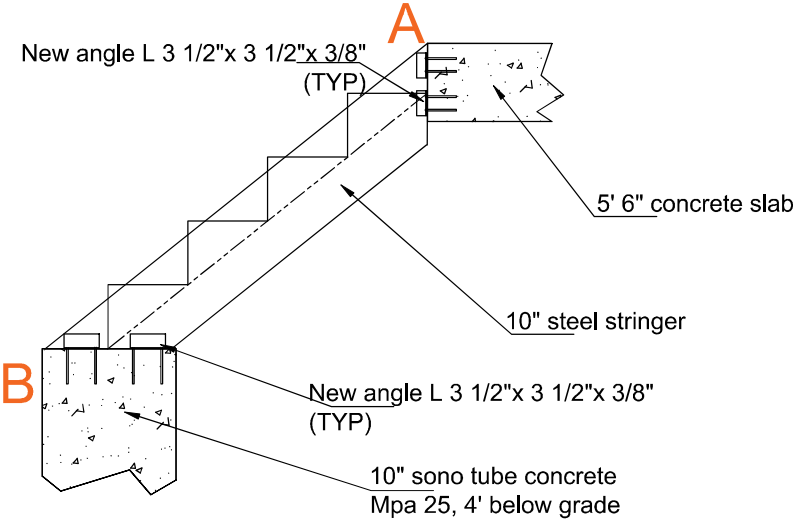

Steel Stringer detail
N.T.S

- 1-Drill holes into concrete using hammer drill bit 1/2" to have room for 3/8" x 6" (1 anchor bolt) Titan HD anchor Simpson Strong tie heavy duty.
- 2-Blowing dust off ,also with pressure wash out for every holes
- 3-Filling $\frac{2}{3}$ of length of holes with high strength anchoring Epoxy (Sakrete).
- 4- push down clockwise anchor bolt slowly to the holes via using angle
- 5- after a few hours welding angle to steel stringer

Design & Drawings

Design Professional Engineering Inc.
23 LORRAINE DR, NORTH YORK
Call (647)3888653 permitcity@yahoo.ca

GENERAL NOTES:
1.DRAWINGS ARE TO BE READ NOT SCALED.
2.CONFORM TO THE REQUIREMENTS OF THE ONTARIO BUILDING CODE INCLUDING ALL STANDARDS REFERENCED THEREIN AND ANY APPLICABLE ACTS OF HAVING JURISDICTION (THE LATEST VERSION OF STANDARDS AND CODES SHALL APPLY).
3.CONTRACTOR SHALL CHECK ALL DIMENSIONS ON WORKING DRAWINGS AND REPORT ANY DISCREPANCIES TO THE ENGINEER BEFORE PROCEEDING ANY CHANGES, ALTERATIONS, OR REVISIONS MUST BE REPORTED TO ENGINEER BEFORE PROCEEDING WITH WORK.
4.THE LATEST DRAWINGS SHOULD BE USED BY CONTRACTOR.



PROJECT:
196 Werry Ave,
Southgate

DRAWING TITLE:
Connection Details

DATE:	PROJECT NO:
SCALE: 3/16" = 1'-0"	11-01
	DRAWING NO:
CHECKED BY:	A-8
APPROVED BY:	